

# SNAP SHIPS®

BUILD TO BATTLE®

## TUNNELWEB

K.L.A.W.  
SPIDER MECH  
BUILD #1 - P. 4



K.L.A.W.  
LIGHT ATTACK MECH  
BUILD #2 - P. 18

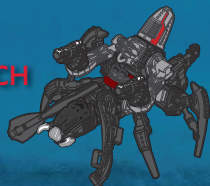



**APP**  
Ask a Parent First

Download  
the Snap Ships  
app for  
interactive  
builds  
and play

## **THE THREAT TO HUMANITY CONTINUES...**

The brutal aliens of the Komplex are still spreading through the galaxy in an attempt to defeat and assimilate all other species. The elite team of the Forge is humanity's last line of defense against the enemy threat.

With the versatile, modular spacecrafts known as Snap Ships, both the Komplex and Forge have an armada of attack crafts, bombers, drones, mechs and more to configure and reconfigure to optimize their strengths in the fight to survive.

Now that you are part of the Snap Ships universe, how will you

►► **BUILD TO BATTLE?! ◀◀**

## **THE MYSTERY OF UJU TECH**

An ancient civilization, UJU KON, has left behind their advanced technology. The Forge and Komplex find and collect these tech pieces to add to their Snap Ships for more power and unheard-of abilities. Unlike the modular Snap Ship parts, UJU tech is a flexible material for more creative connections.



**Watch Action-Packed Videos!**



## **TUNNELWEB** K.L.A.W. SPIDER MECH

With its dexterous legs, Tunnelweb can navigate over inhospitable terrain for close-quarter combat. Its tail-mounted grapple hook allows it to ascend obstacles to get into advantageous positions. It's features include:

- **K.L.A.W. GRAPPLE LAUNCHER** for hook action
- **CL-ARC MORTAR**, a high trajectory mortar cannon
- **KINETIC SHIELDING** to protect from enemy fire

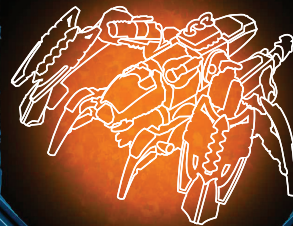

## **WHICH UJU TECH WILL YOU FIND?**

There are two powerful UJU tech pieces for you to find—how will you use them to maximize your ship's capabilities?

**PILOT**



This ship is piloted  
by a Komplex Pilot.

Are you ready to **BUILD TO BATTLE?**

Includes: 32 Building Pieces, 5 Accessories, 2 Projectiles, Instructions.  
Not every build will use every component—it's OK to leave some pieces in the hangar for later!



# TUNNELWEB

K.L.A.W. SPIDER MECH

**BUILD #1**

# 1

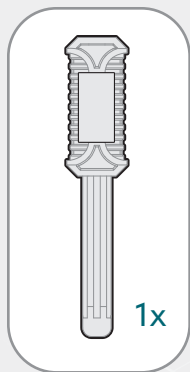

**Separation Tool**

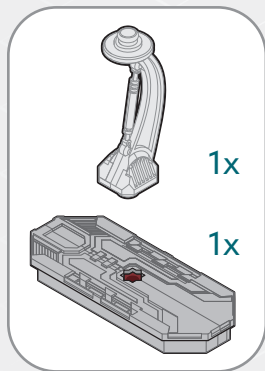
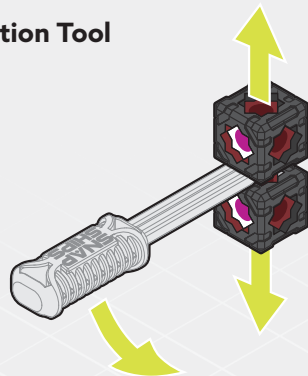

**Box top is also a display stand**

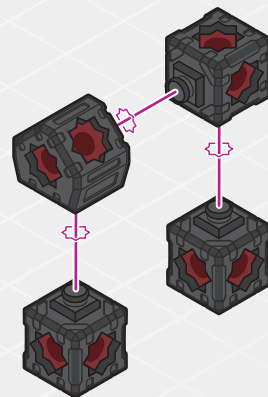
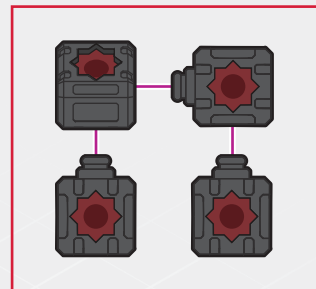
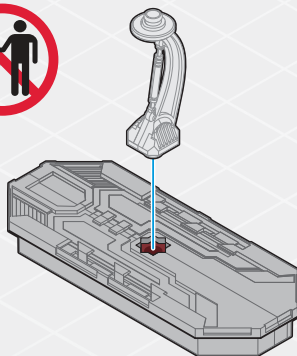

# 2

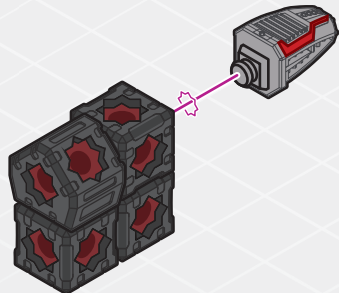
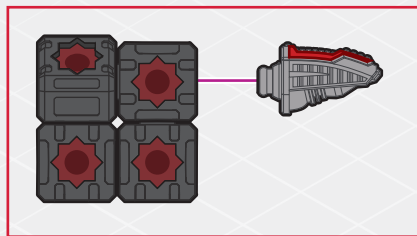

# 3

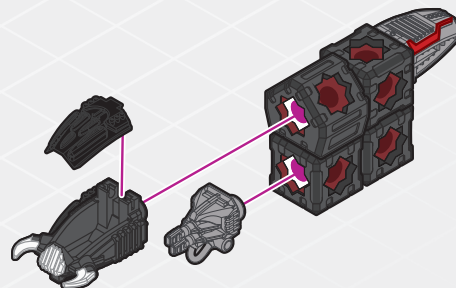
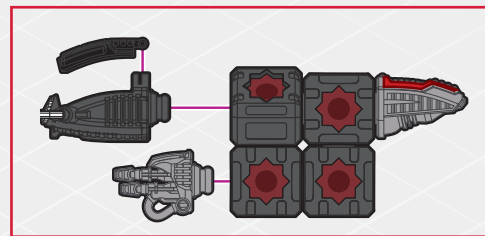
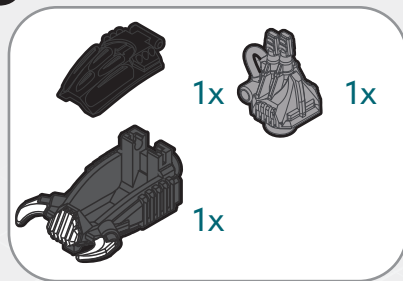

# 4



1x

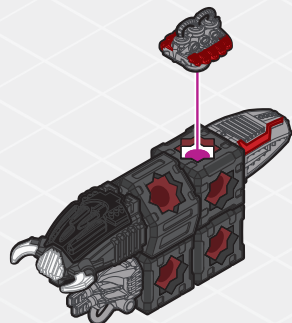
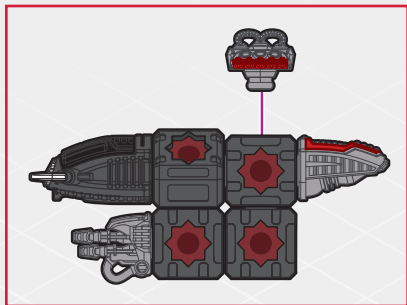

# 5



2x

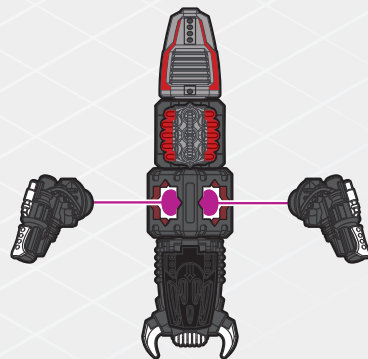
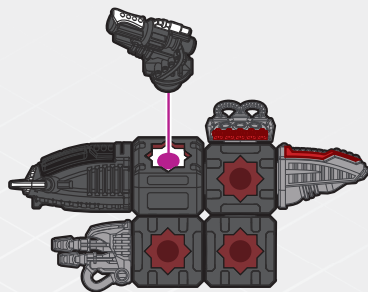

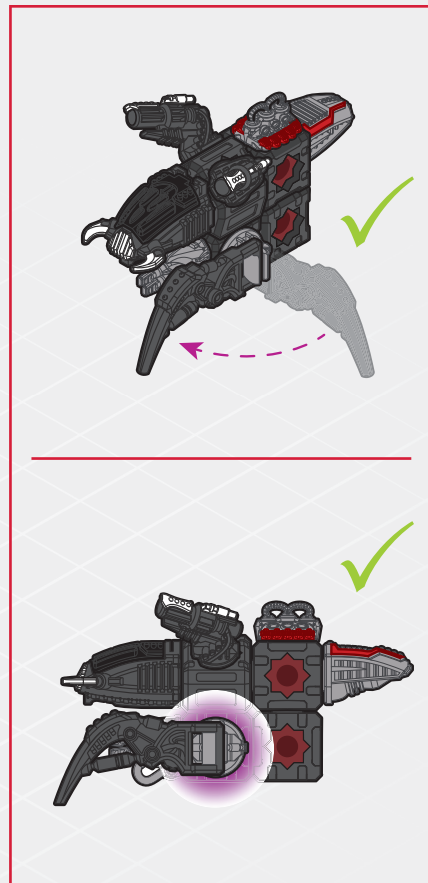
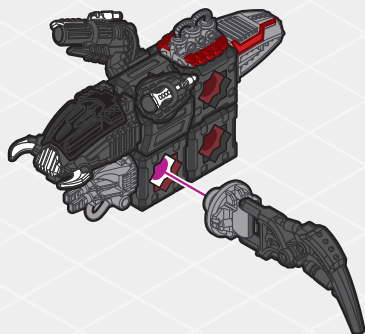
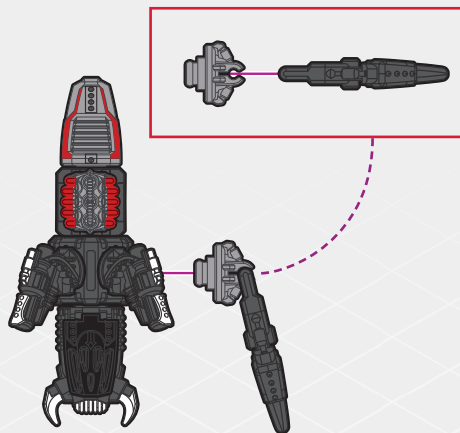
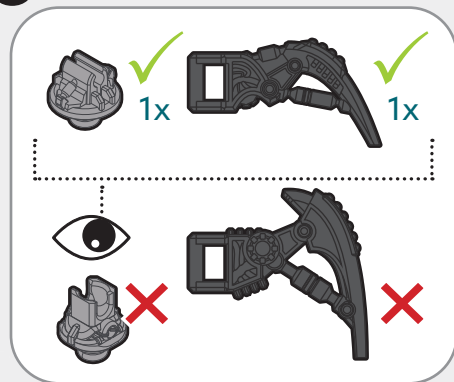

# 7

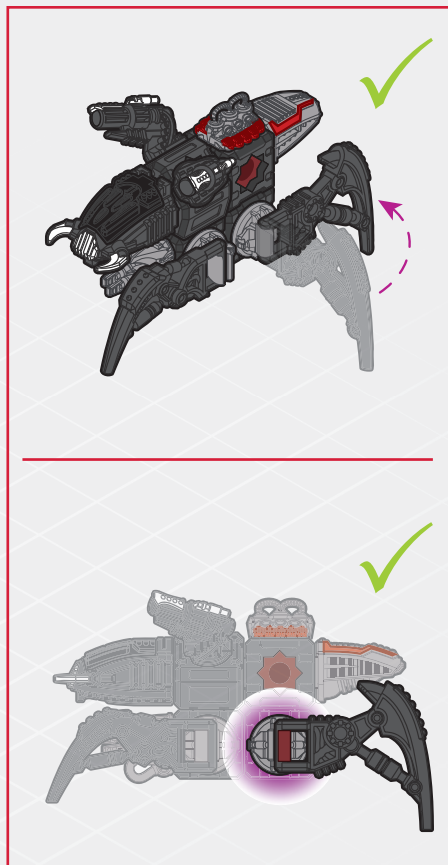
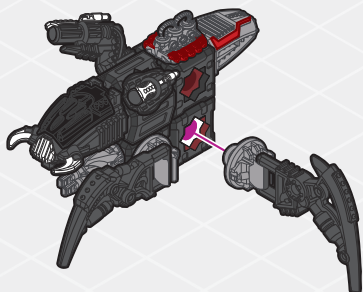
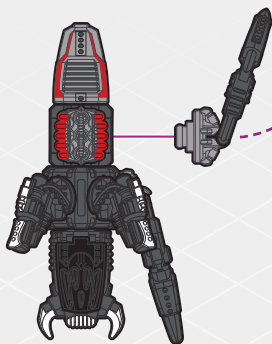
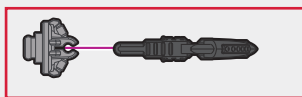
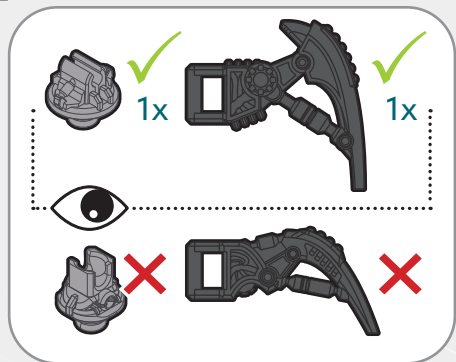

8

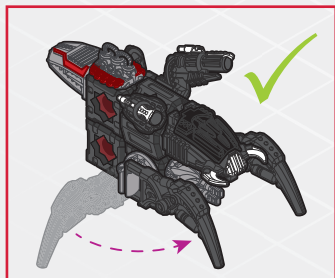
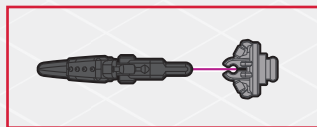
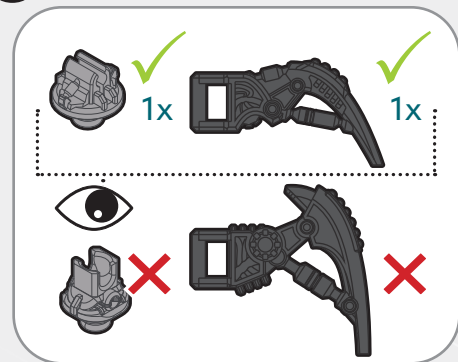

9

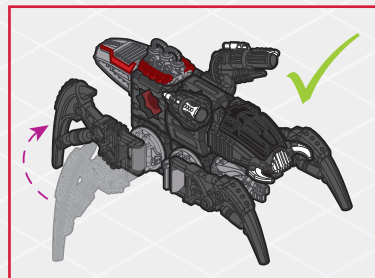
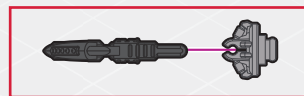
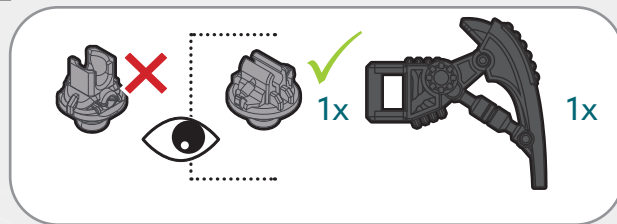

# 10

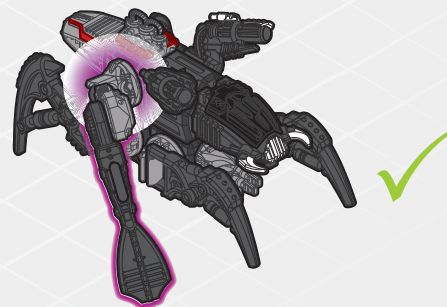
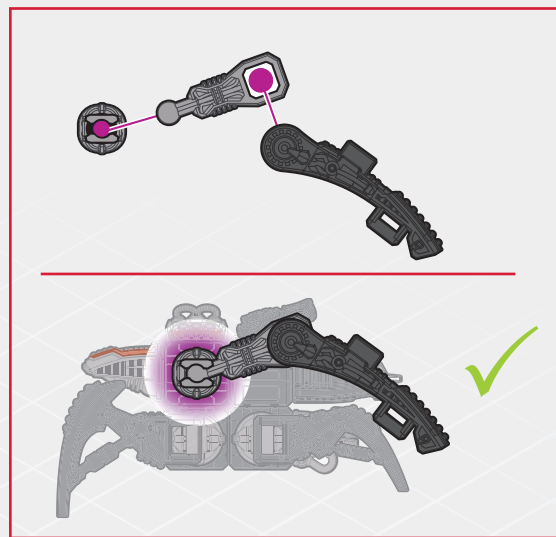
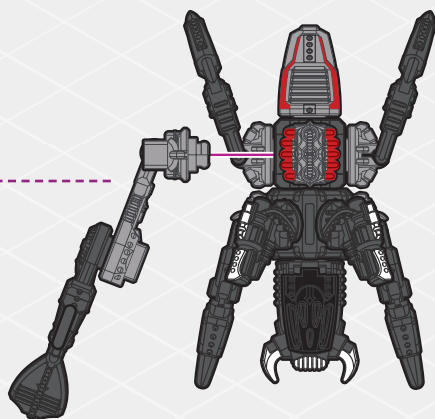
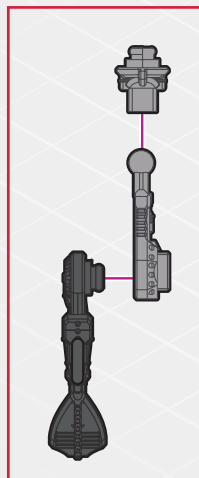
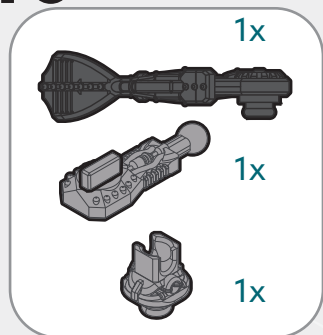

# 11

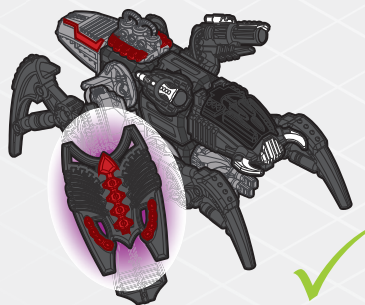
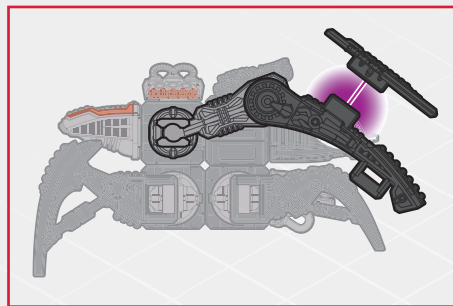
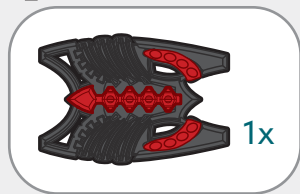

# 12

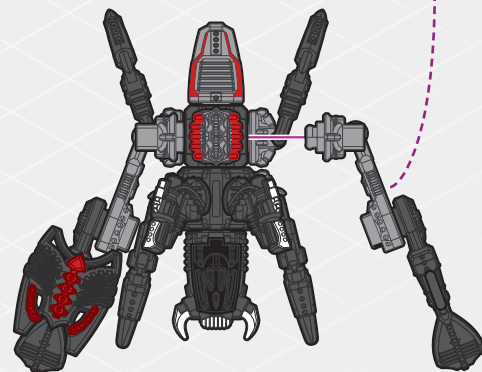
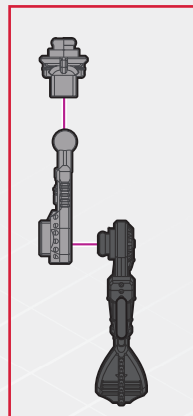
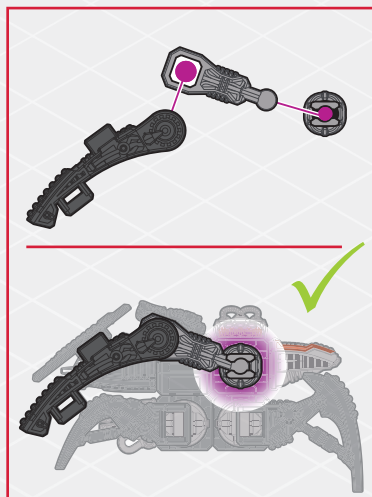
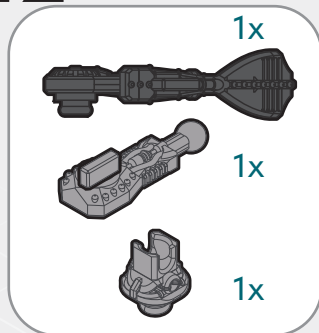

# 13

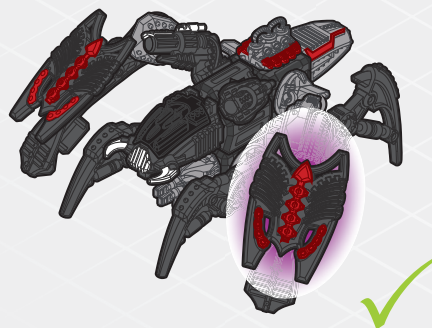
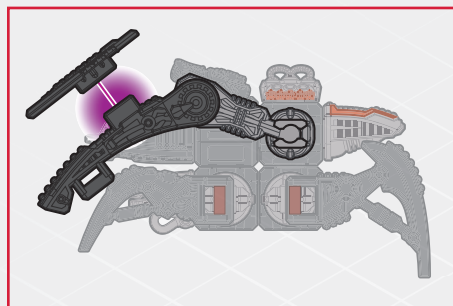

# 14

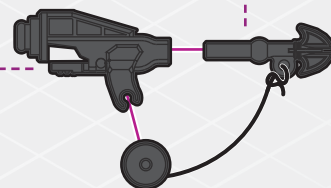
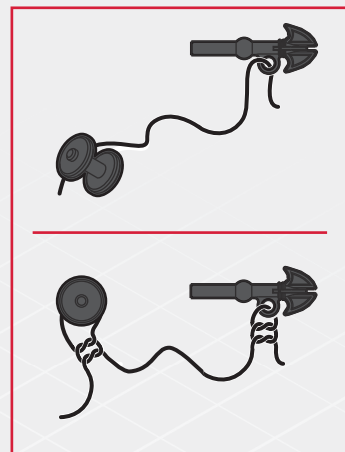
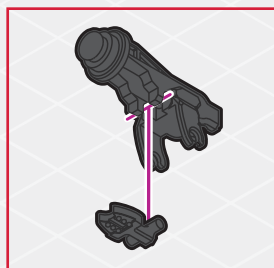

# 15

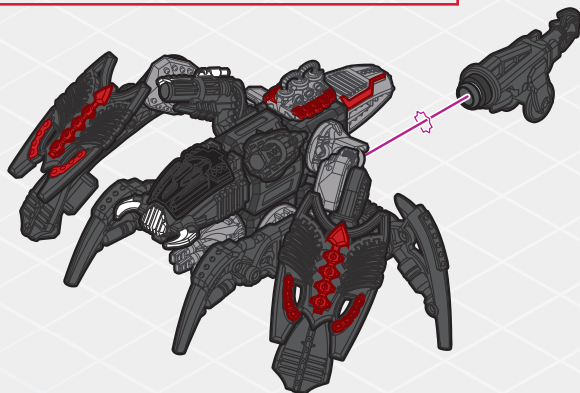
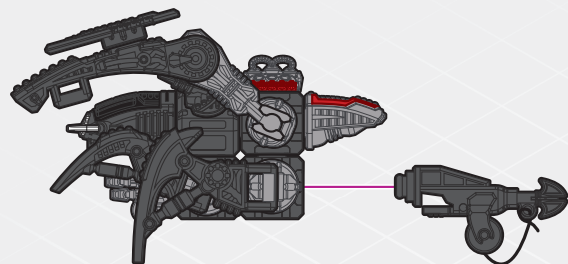

# 16

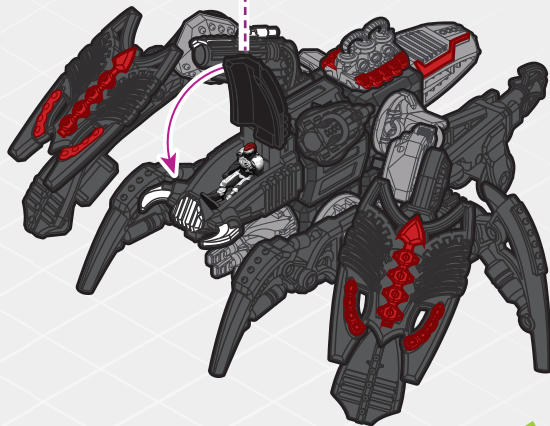

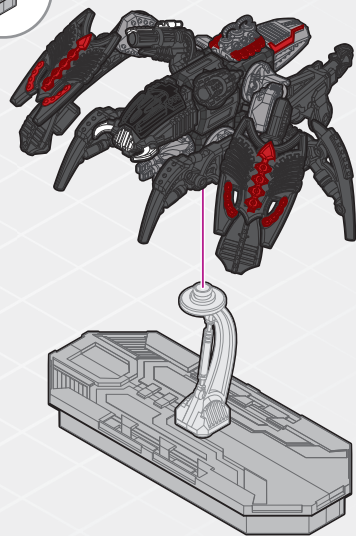
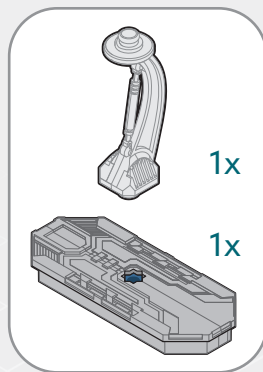
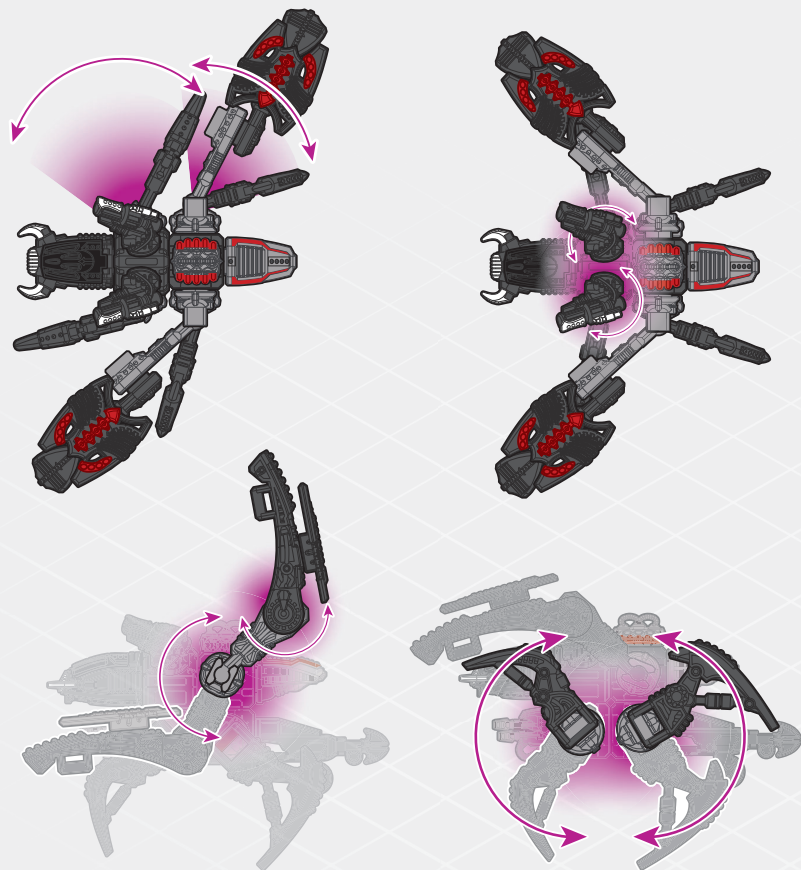

Continue searching for the rest when you collect more Snap Ships!

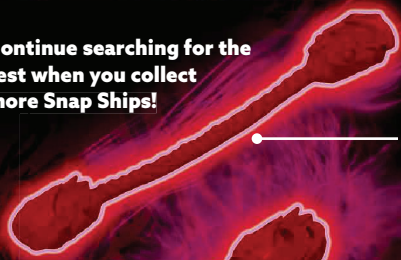

**K-34  
ENERGY COUPLER**



**K-38  
THORN THROWER**



**K-13  
STATIC VANES**

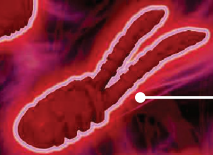

**K-55  
GRAPPLING  
TENDRILS**



**K-8  
MANEUVERING  
FINS**

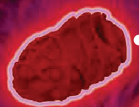

**K-51  
REGENERATION  
POD**

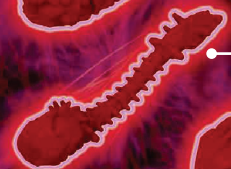

**K-25  
ARC WHIP**



**K-19  
CARAPACE POD**

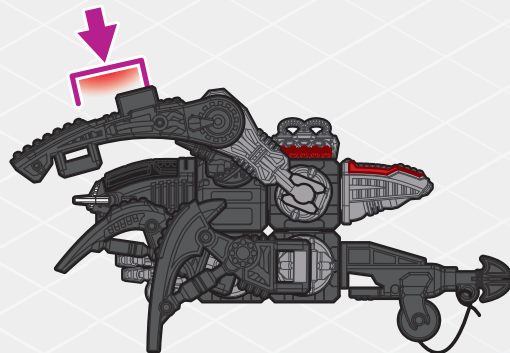
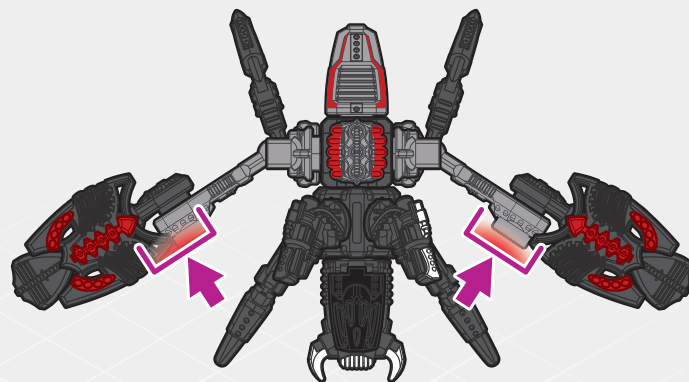

 **WARNING:**  
EYE IMPACT HAZARD—Do not  
aim at eyes or face.

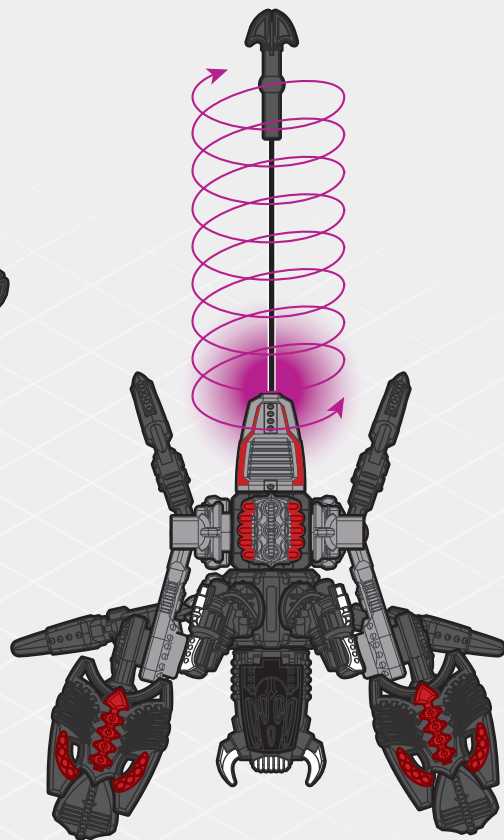
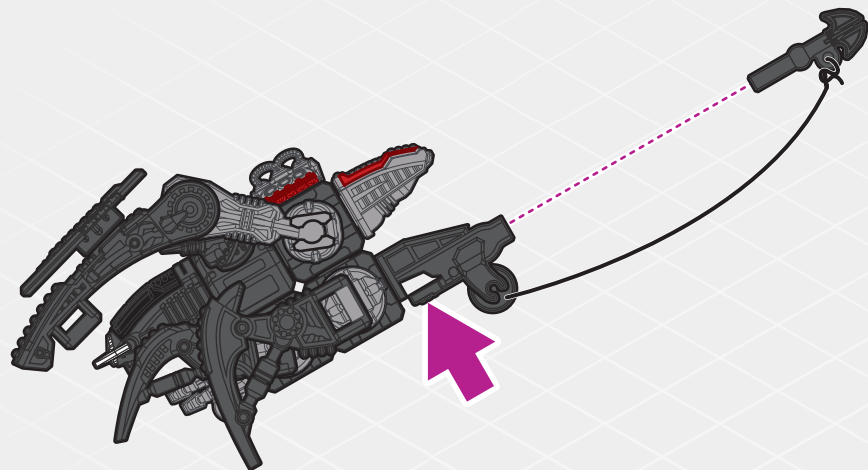

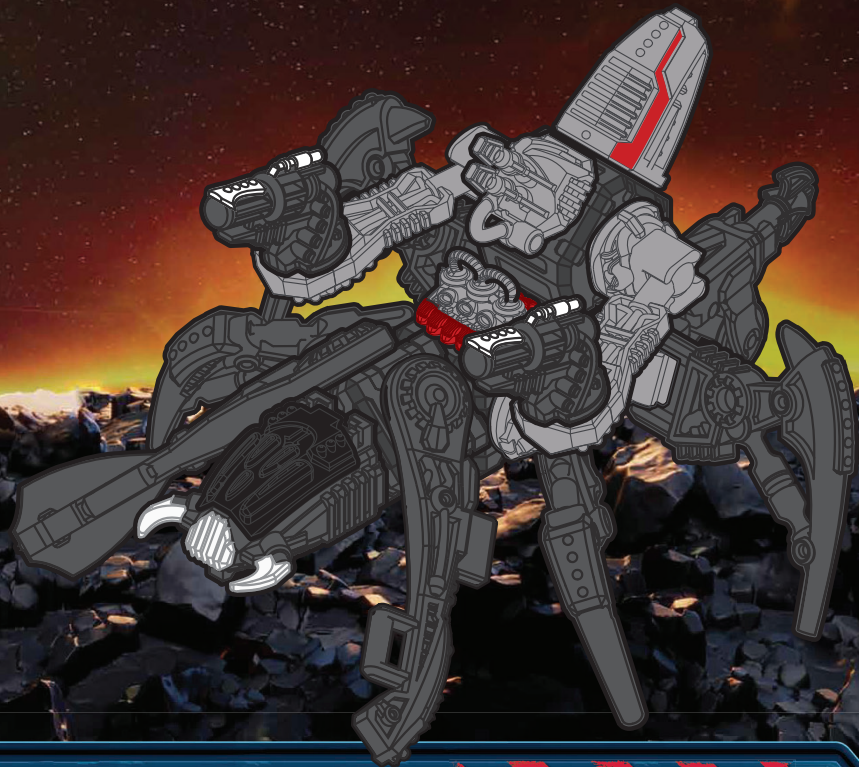

# **TUNNELWEB**

K.L.A.W.  
LIGHT ATTACK MECH

**BUILD #2**

1



1x



1x

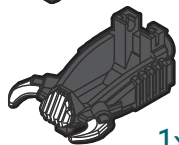

1x

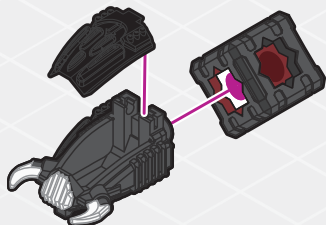
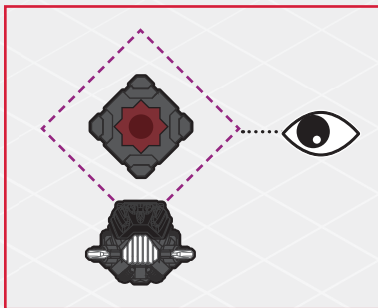
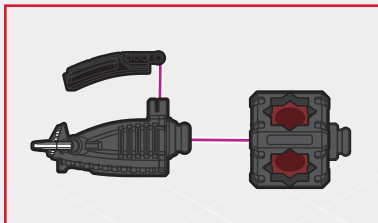

2



2x

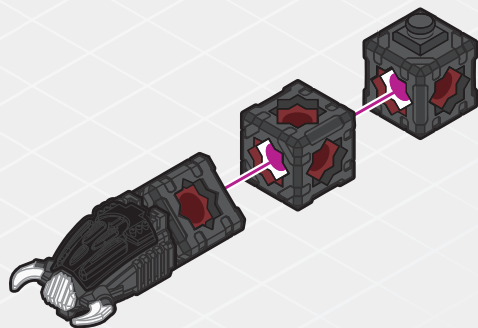
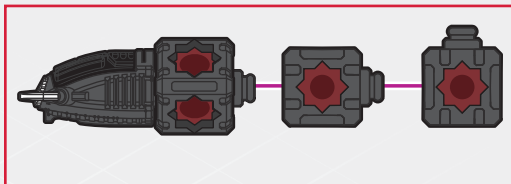

3



1x



1x

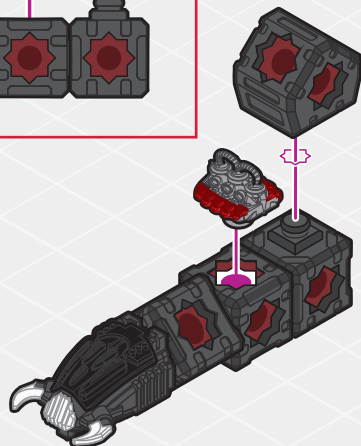
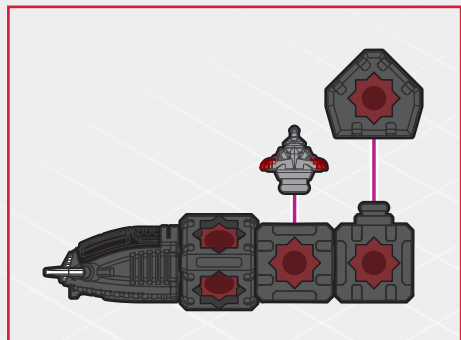

4



1x



1x

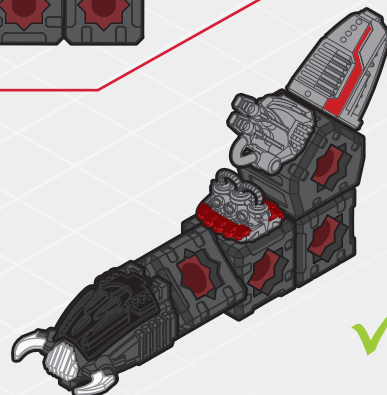
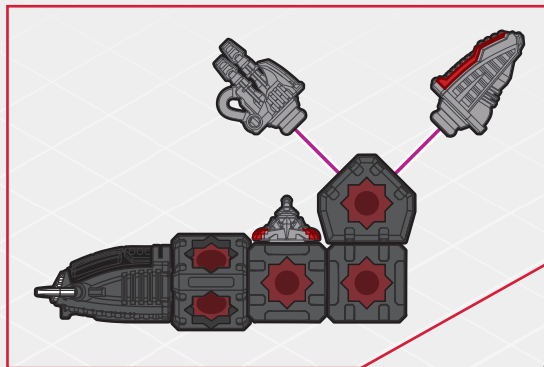

5



1x



1x



1x

1x



1x

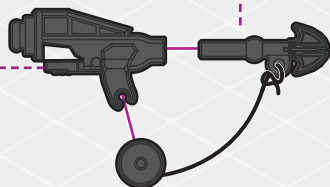
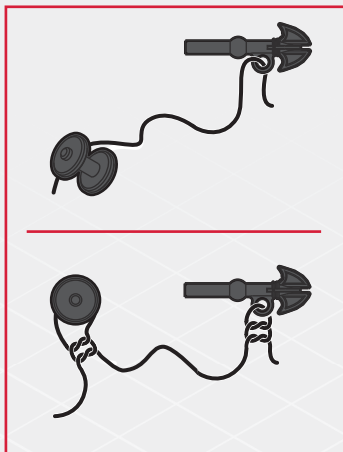
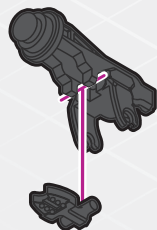

6

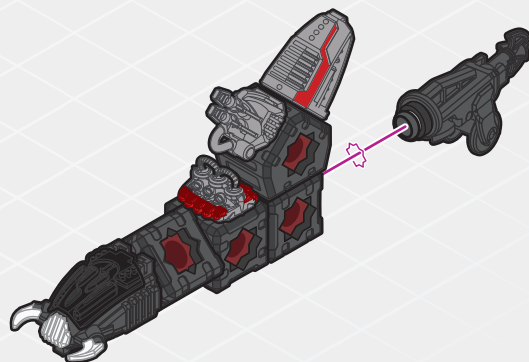
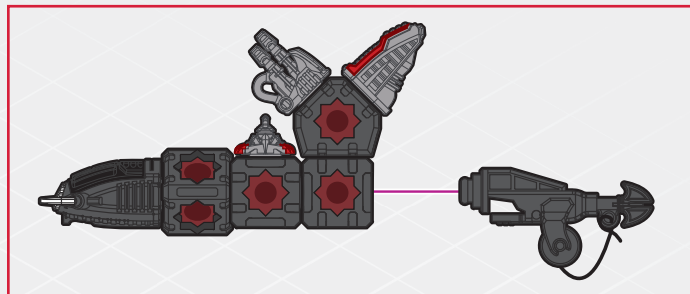

7

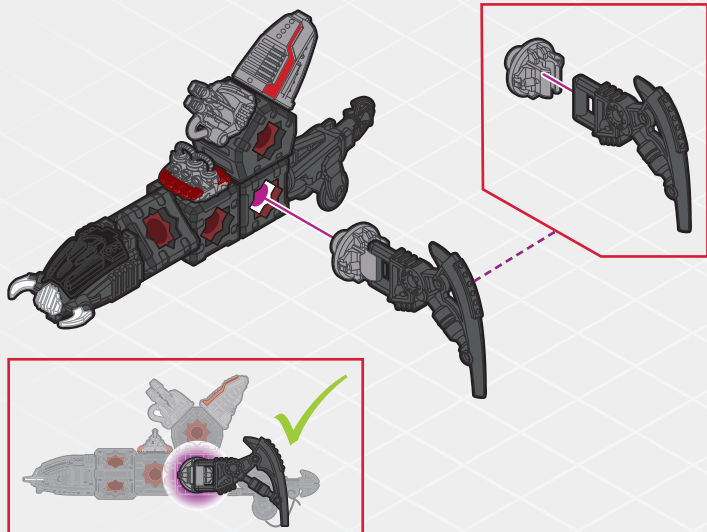
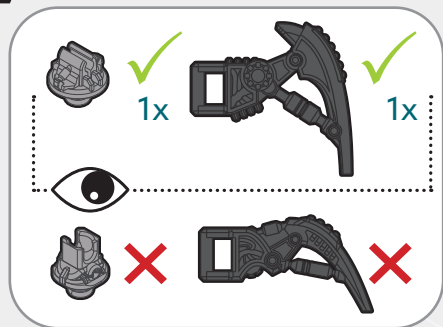

8

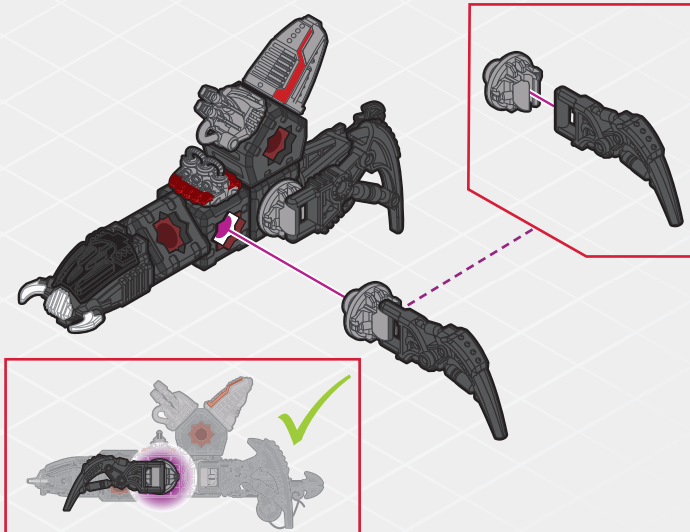
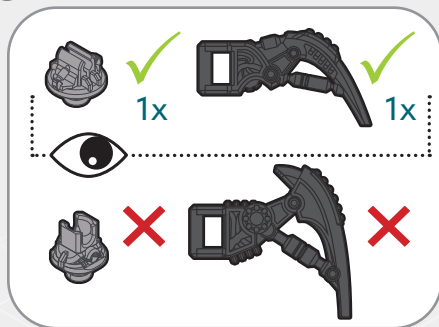

9

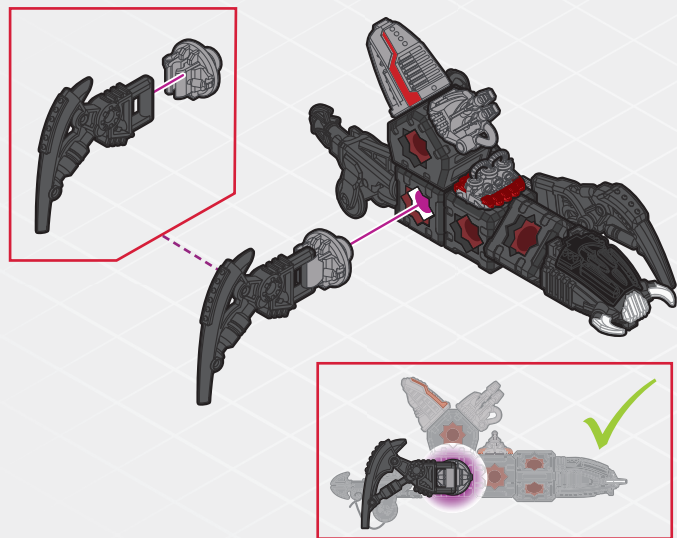
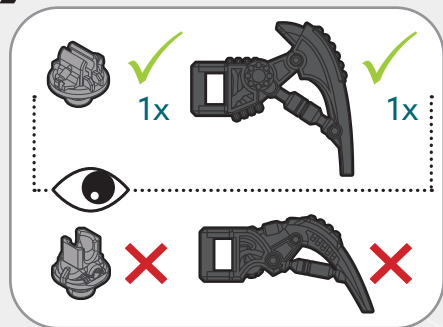

10

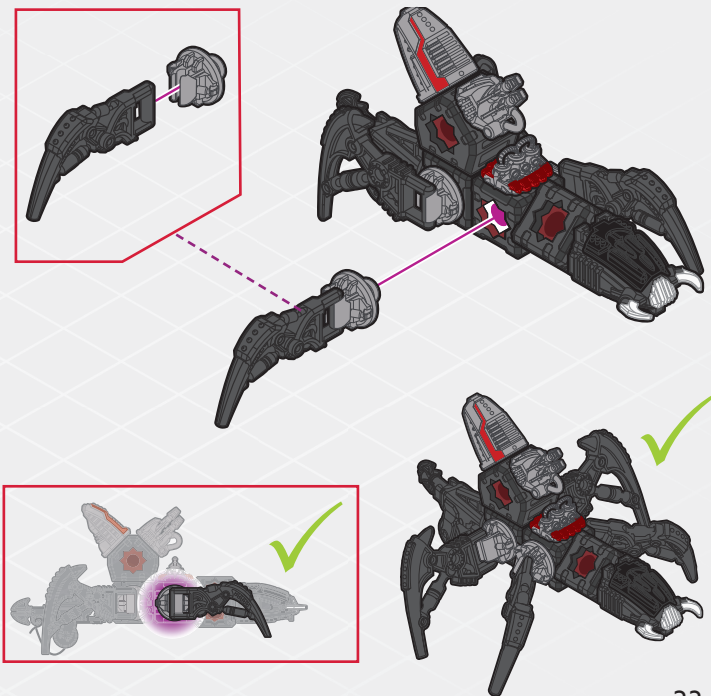
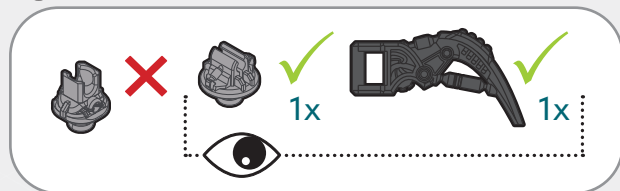

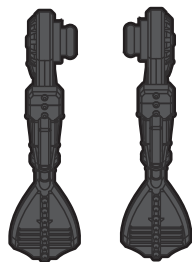

1x

1x

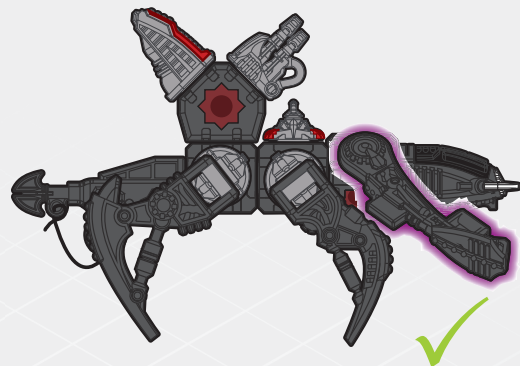
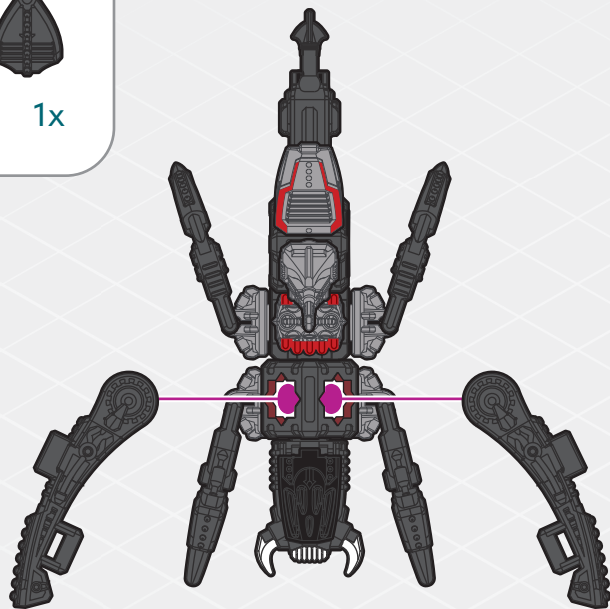

# 12



2x

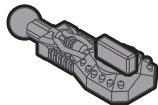

2x

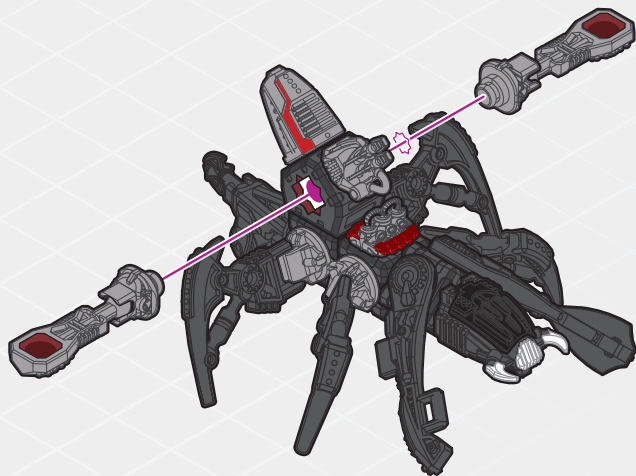
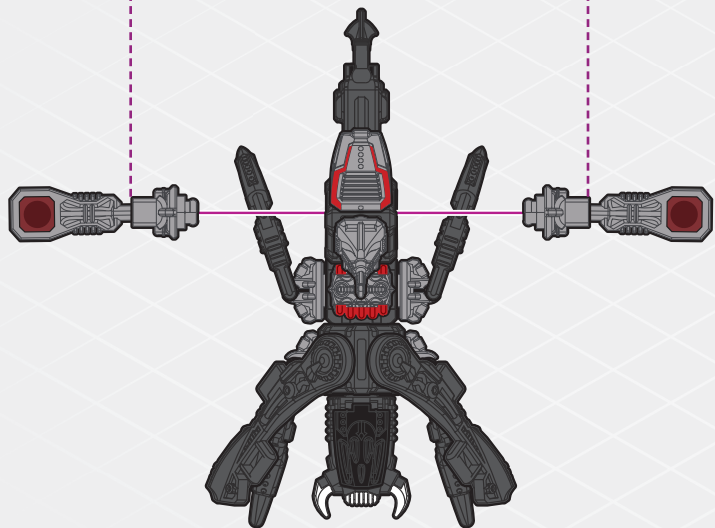
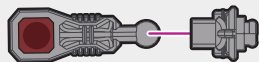

# 13



2x

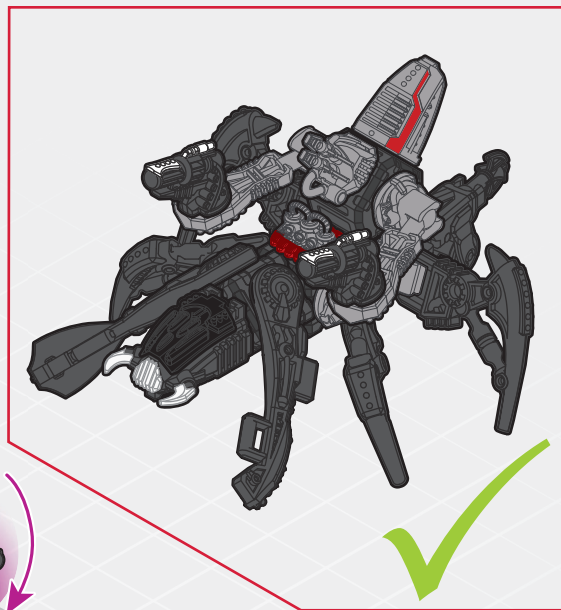
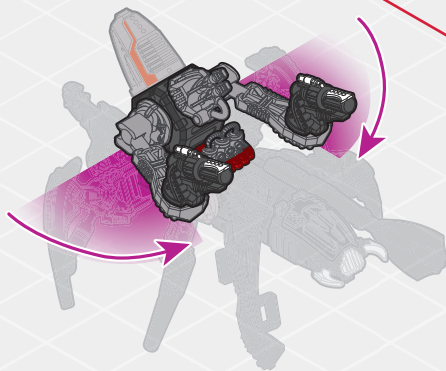
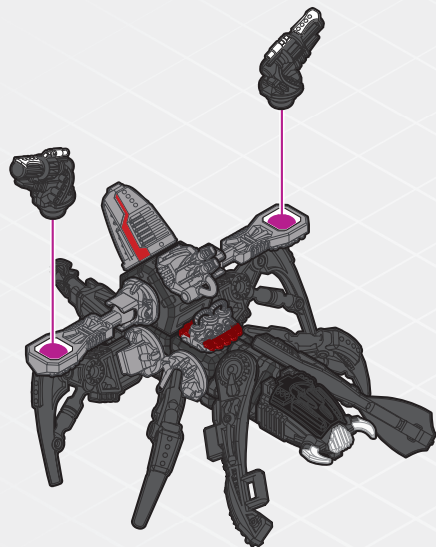



3x



1x



1x



1x

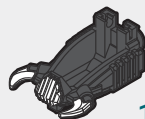

1x



1x



1x



1x



2x



4x



2x



2x



2x

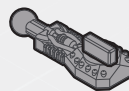

2x



1x



1x



2x



1x



1x



1x



1x



1x



2x



1x

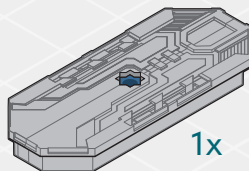

1x



1x

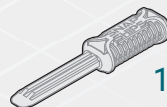

1x



APP  
Ask a Parent First

Download  
the Snap Ships  
app for  
interactive  
builds  
and play

COLLECT THEM ALL!



[www.snapships.com](http://www.snapships.com)

**Watch Action-Packed Videos!**

9523

Instructions can be downloaded at:  
**snapships.com**

If you have questions, please contact us.  
**800-524-4263 • Weekdays 8am to 5pm CST**  
**[playmonster.com/contact-us](http://playmonster.com/contact-us)**

**PlayMonster**



Copyright © 2021 PlayMonster LLC, 1400 E. Inman Pkwy., Beloit, WI 53511 USA.  
Made in China. All rights reserved. **Snap Ships** and *Build to Battle* are trademarks of  
**Snap Ships, LLC. Snap Ships** used under license. Copyright © 2021 **Snap Ships, LLC.**  
Parts and colors may vary from those shown. Invented by Scott Pease and Jeff Swenty.